

# STAINLESS STEEL TROLLEY XTS



## 2 YEARS WARRANTY

Compliant with ASME B30.17

## TECHNICAL SHEET

Wheels with radial ball bearings and sealed cage

Compatible with I and H beams (S and W profile)

Made of AISI 304 stainless steel

Designed for food grade and outdoor applications

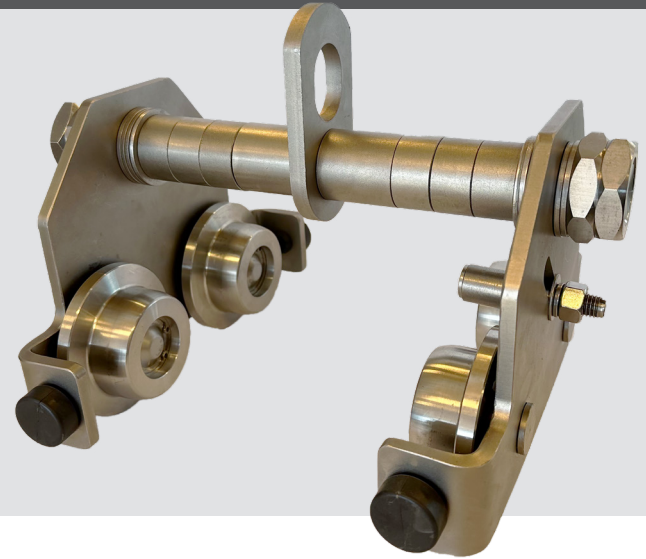

## TECHNICAL SPECS

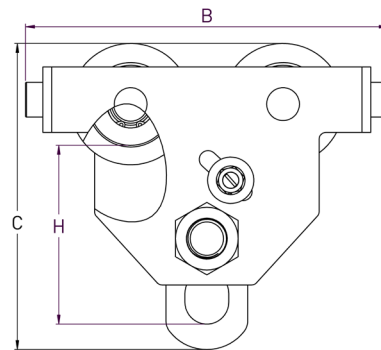
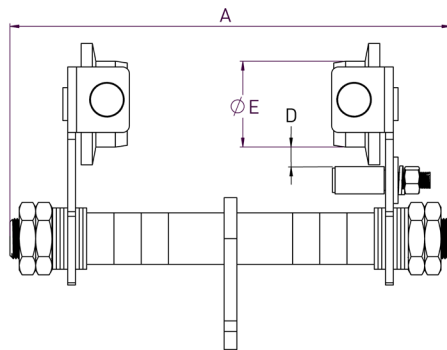

Model	Capacity, metric Ton [lbs ; short ton ; kg]	Beam width (min - max) in	Min. curve radius in	Weight*, (lbs)	Dimensions*, in					
					A	B	C	D	E <sup>Ø</sup>	H
SPT0.25T	0.25 [551; 0,27; 250]	2.00 - 6.00	40	8	10,0	8,6	6,8	1,33	1,78	4,0
SPT0.5T	0.5 [1102; 0,55; 500]	2.50 - 8.00	40	14	12,2	9,3	7,8	1,08	2,05	4,06
SPT01T	1.0 [2204; 1,10; 1000]	2.50 - 8.00	40	23	12,8	10,5	8,8	1,47	2,49	5,1
SPT02T	2.0 [4409; 2,20; 2000]	3.50 - 8.00	52	40	13,4	11,7	10,6	1,29	2,68	6,3
SPT03T	3.0 [6613; 3,30; 3000]	4.00 - 8.00	52	82	14,6	13,6	13,0	1,45	3,63	7,8
SPT05T	5.0 [11023; 5,51; 5000]	4.00 - 8.00	63	106	16,5	16,0	15,1	1,62	3,86	9,1

\* Approximate values. Actual values may slightly differ.