

0.75ton

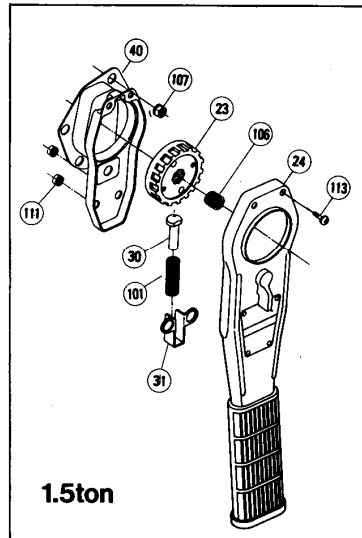

1.5ton

3ton

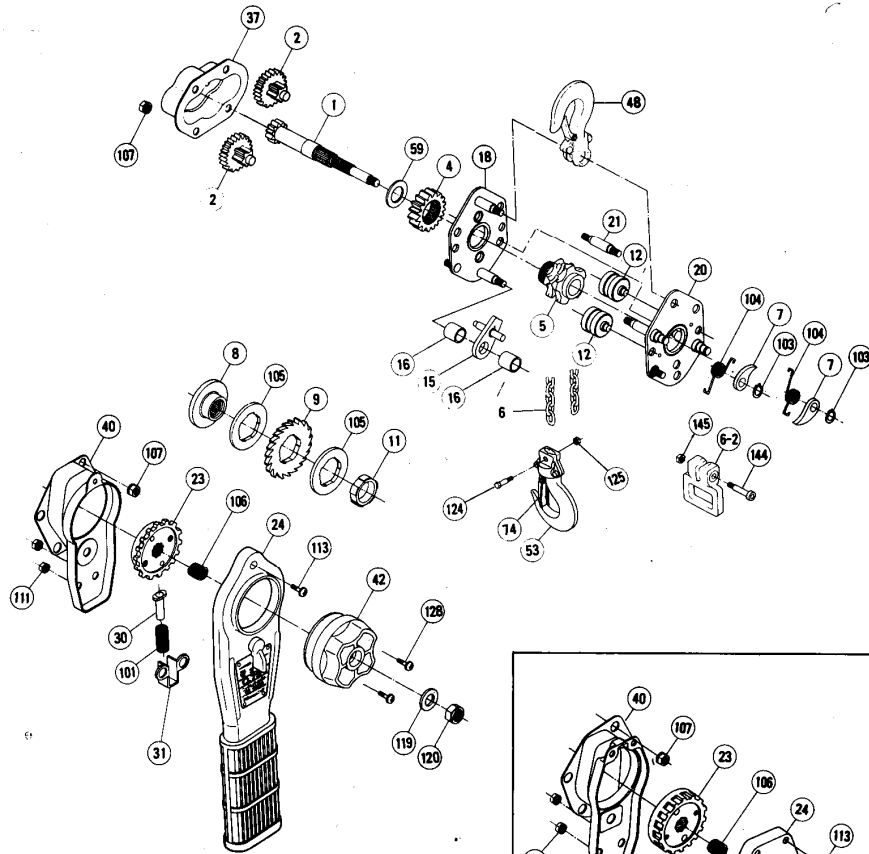
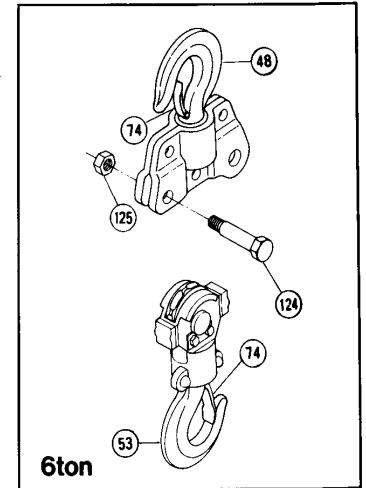
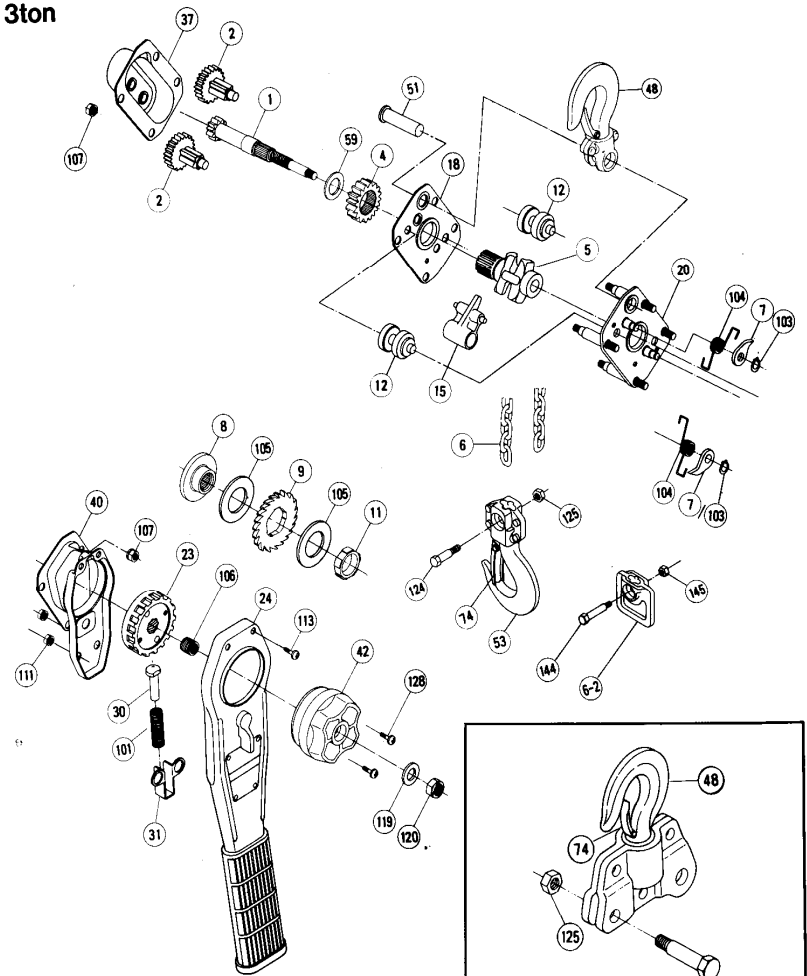

6ton

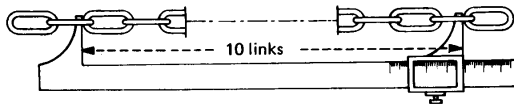

Load Chains Dimensions

Capacity ton	Diameter ϕ mm	Standard (mm)	LIMIT (mm)
0.75	5.6	171	174.4
1.5	7.1	212	216.2
3 & 6	9	273	278.5

(10 links dimensions)

Hook Dimensions (Opening)

Capacity ton	Standard Size (mm)	LIMIT *A (mm)
0.75	30	33
1.5	39	43
3	42	46
6	56	60

NOTE: Limit *A(mm) are the maximum permissible dimensions of the Hooks, which are about 10% wider than the standard hook openings.

